



# Multi-Loader

ML 300



## Multi-Loader ML 300

A	2651 mm	J	160 mm
B	124 mm	K	380 mm
C	35 mm	L	66°
D	1162 mm	M	28°
E	1708 mm	N	900 mm
F	1867 mm	O	970 mm
G	2052 mm	T	1404 mm
H	1364 mm	Q	29°

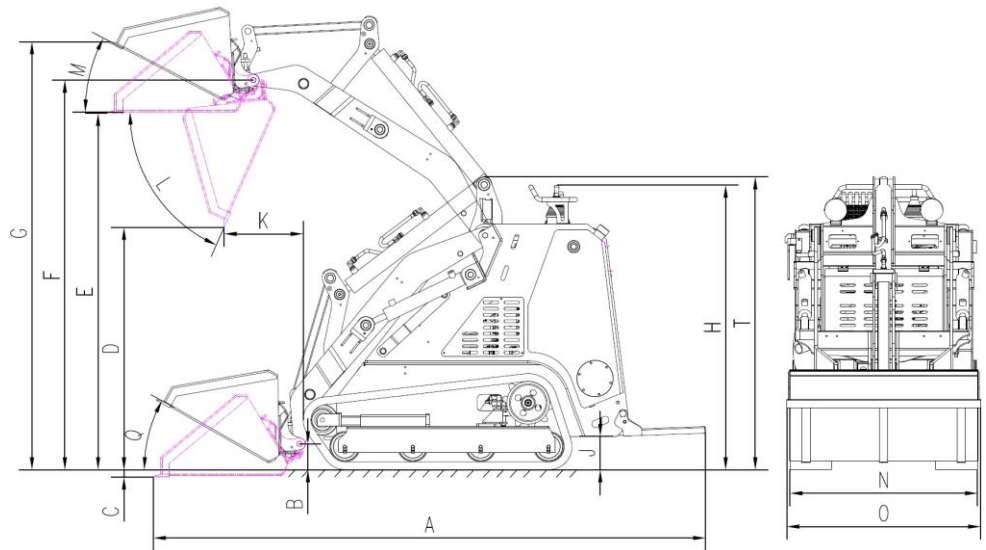

### Technical Details

<b>Motor</b>	
Honda	GX 690
Type	2 cyl. / 4-stroke
Displacement	688 cm <sup>3</sup>
Engine output	18,4 kW (25,0 HP)
Revolution speed	3600 rpm
Starter	electric starter
Air filter	dry cell
Fuel filter	gauze
<b>Drive</b>	
	hydrostatic
<b>Guidance</b>	
	hydraulic motor Danfoss
<b>Multi-valve block</b>	
	Hydrocontrol Italy
<b>hydraulic pump</b>	
	Permco USA
<b>Characteristic</b>	
	quick-change system joystick control, electric start



<b>operating data</b>	
weight without accessory	1050 kg
max. payload	300 kg
max. operating weight (loaded)	1350 kg
tipping device	hydraulic
climbing ability	max. 20° (36%)
working speed	0 – 5 km/h
oil pressure	180 bar
flow rate oil pump	24.6 ltr./min.
bucket capacity standard bucket	120 ltr.

<b>accessory</b>	4 in 1 shovel, excavator, pallet fork, gripper (croco), trencher, demolition hammer, auger Ø 200mm / 300mm
------------------	--



### Baumaschinen GmbH

Niederhöchstädter Str. 71-73 D-61476 Kronberg  
 Tel.: 0049-(0)6173-68558 Fax: 0049-(0)6173-68548  
 E-Mail: info@powerpac.de Internet: www.powerpac.de