



Track-Dumper

optional platform



extendable side walls



RD 560



Track-Dumper RD 560

Technical Data

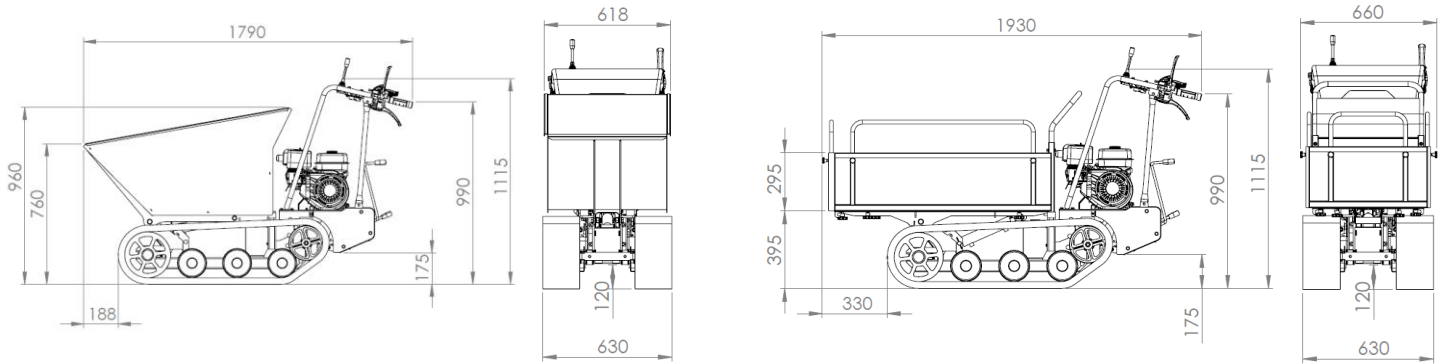

engine	
Honda	GX 200
Type	1 cyl. / 4-stroke
Displacement	196 cm ³
Engine output	4,8 kW (6,5 HP)
Revolution speed	3600/rpm
Starter	reversing + electric starter
Air filter	dry cell
Fuel filter	gauze



drive	toothed gearing
steering	steering clutch
build options	dumper box or loading platform
characteristic	The loading area can be increased by pulling out the load carrying beds. Load carrying beds can be complete pull out.
adjustable load carrying side walls	length variable 1090 - 1180 mm width variable 540 - 1340 mm height standard side walls 295 mm + height increases side walls 305 mm



operating data	
weight	205 kg
max. payload	560 kg
max. weight (loaded)	765 kg
tipping device	hydraulic
climbing ability	max. 26° (50%)
working speed 6+2	0,50 - 1,30 km/h gear 1-3 forward 1,80 - 4,90 km/h gear 4-6 forward 0,60 - 2,30 km/h gear 1-2 reverse
oil pressure	160 bar
flow rate oil pump	9,6 ltr./min.
dumper box volume	250 ltr.
platform volume	170 ltr.





Baumaschinen GmbH
 Niederhöchstädter Str. 71-73 D-61476 Kronberg
 Tel.: 0049-(0)6173-68558 Fax: 0049-(0)6173-68548
 E-Mail: info@powerpac.de Internet: www.powerpac.de

